



Features

- Working pressure 210 bar (3000psi) hydraulic hose with crimped end connections
- Steel wire reinforced, oil and weather resistant synthetic rubber covering
- Working temperature -40°C to 100°C
- Available with JIC 37° or NPTF threaded ends



Ordering Details

HA	Hose Assembly	Code	Hose Diameter, inch	Max. O.D. mm	Min I.D. mm	Kg/ft
8-	Hose Size	4	1/4"	13.2	6.2	0.064
		6	3/8"	17.0	9.5	0.098
		8	1/2"	21.1	12.7	0.128
		10	5/8"	25.9	15.8	0.223
		12	3/4"	30.3	18.8	0.283
		16	1"	38.6	25.0	0.402

Code	Thread	Used with Hose code	Illustration
J.2	1/4", 7/16x20, JIC, 37°	4	
J.3	3/8", 9/16"-18 JIC, 37°	4,6,8	
J.5	1/2", 3/4"-16, JIC, 37°	6, 8	
J.6	5/8", 7/8"-14, JIC, 37°	8, 10	
J.75	3/4", 1 1/16-12, JIC, 37°	10,12	
J1	1", 1 5/16-12, JIC, 37°	16	
N.25	1/4" -18 NPTF	4	
N.3	3/8"-18 NPTF	4,6,8	
N.5	1/2" -14 NPTF	6, 8	
N.75	3/4"-14 NPT	10,12	
N1	1" 11-1/2 NPT	16	

J.5-	End 1 Connection	Code	Connection Angle	Illustration
90-	End 1 fitting angle:	S	Straight JIC w/swivel NPT no swivel	
		45	45° w/swivel	
		90	90° w/swivel	

180- End 1 assembly angle with reference end 2 at 180° (blank if straight fitting on either end)

J.5- End 2 Connection:

90- End 2 fitting angle:

24- Hose Length (inch), L1

1 Series

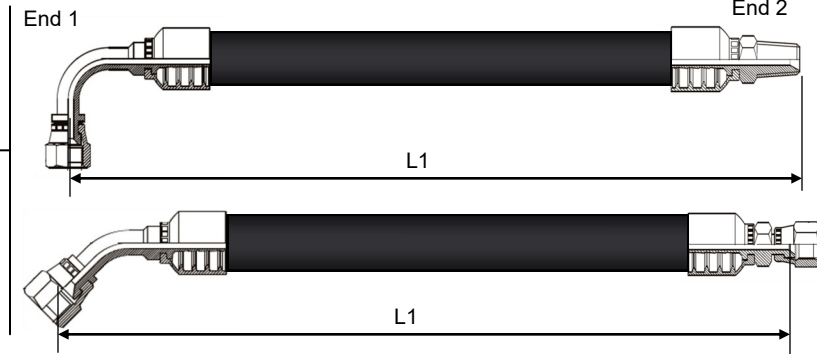
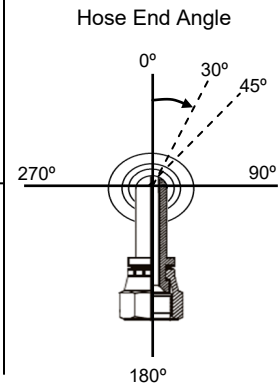

Example Part Number: HA8-J.5-90-180-J.5-90-180-24-1

Abrasive Hose Cover (order separately)



Material = Nylon

Code	Length (inch)	I.D. (Inch)
A-0.71-	specify	0.71
A-1.13-	specify	1.13
A-1.59-	specify	1.59
A-2.07-	specify	2.07

Example Part Number: A-1.13-24